

FORM NO. 1.

Courses on the Creek

- 1 S 86 W..10¹/₂
- 2 N 58 W..12
- 3 N 30 W..20
- 4 N 44 W..20¹/₂
- 5 N 40 W..68
- 6 N 28 E..35¹/₂
- 7 S 75 E..20
- 8 N 36 E..16
- 9 N 29 W..30
- 10 S 77 W..10¹/₄
- 11 N 38 W 12
- 12 N 25 W 14¹/₂
- 13 N 5 E 4¹/₄
- 14 N 50 W 12
- 15 N 26 W 6
- 16 N 41 W 27¹/₂
- 17 S 88 W 46¹/₂
- 18 S 80 W 12

377¹/₂

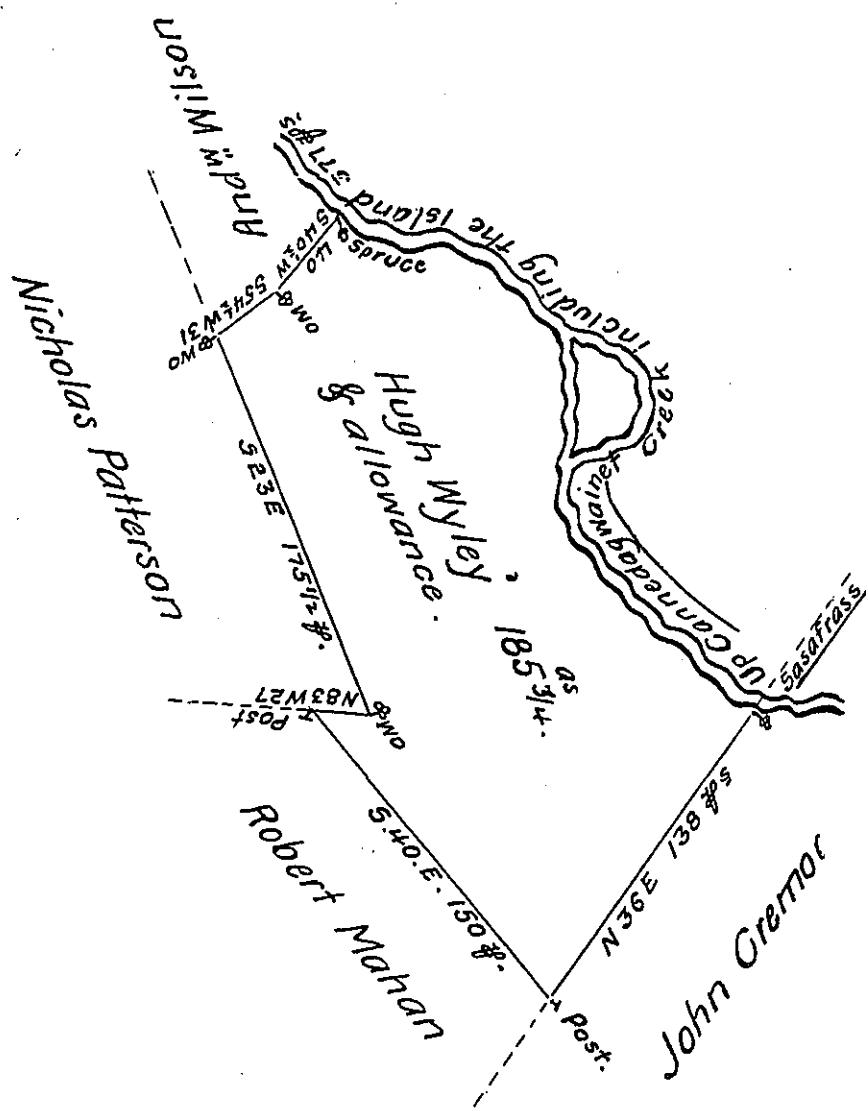

A Draft of a Tract of Land Situate in Letterkenny Township in the County of Franklin Containing one hundred and eighty five Acres and three quarters of an Acre and an Allowance of Six ¹/₂ Cent for Roads &c^a Survey'd March 31st 1786 in pursuance of a Warrant granted to Hugh Wyley bearing Date the 20th Day of February 1786

~~To John Lukens Esq^r~~
~~Surveyor General~~

Matt^m Henderson D5

To Daniel Brodhead Esquire
Surveyor General of Pennsylvania

IN TESTIMONY that the above is a copy of the original remaining on file in the Department of Internal Affairs of Pennsylvania, made conformably to an Act of Assembly approved the 16th day of February 1833, I have hereunto set my hand and caused the Seal of said Department to be affixed at Harrisburg, this thirty-first day of May 1907

Henry Howell
Secretary of Internal Affairs.